

ROBERT E. TALBOT CONSERVATION AREA

LAWRENCE COUNTY
4,360 ACRES

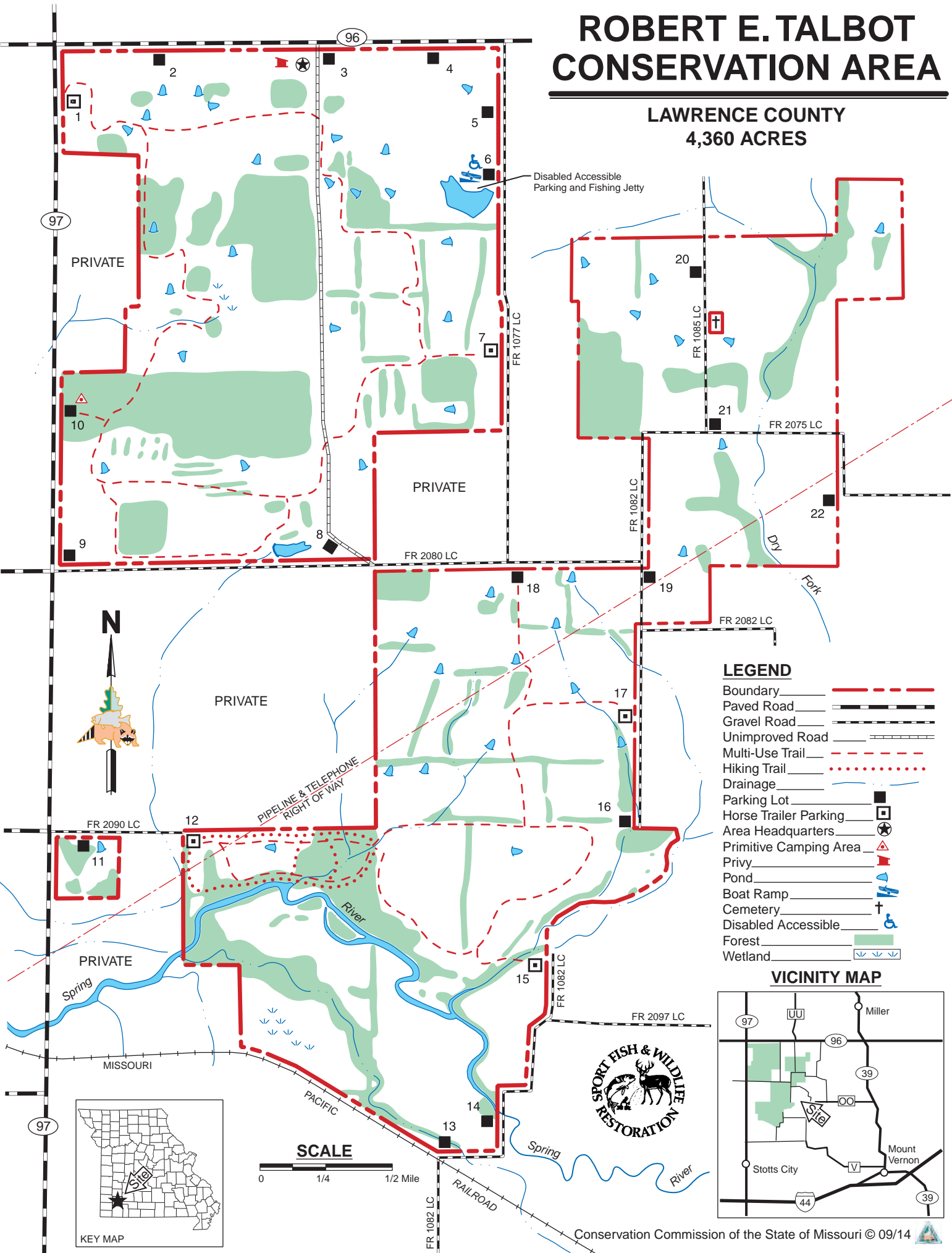

LEGEND

Boundary	
Paved Road	
Gravel Road	
Unimproved Road	
Multi-Use Trail	
Hiking Trail	
Drainage	
Parking Lot	
Horse Trailer Parking	
Area Headquarters	
Primitive Camping Area	
Privy	
Pond	
Boat Ramp	
Cemetery	
Disabled Accessible	
Forest	
Wetland	

